

## ProSeries™ AG LED Utility Luminaire

### Product Data Sheet

Engineered Products Company's (EPCO) ProSeries AG LED Utility Luminaire provides 95% electrical efficiency and is suitable for a variety of lighting applications. High-power LEDs provide excellent white-light distribution with color-rendering quality that portray the true colors of objects. This LED light engine reduces energy consumption, lowers carbon emissions\*, and is ideal for universal lighting system building integration.

Manufactured with high-quality materials and workmanship, this durable IP65 rated environmentally resistant LED light engine uses a solid core, pre-shrunk silicone gasket to ensure a water-tight seal against material debris, water, or moisture ingress. This combination of materials ensures a consistent and sustainable performance at a very cost-effective, competitive price.

### Benefits

- Listed to UL Standard 1598 (tested).
- Energy Saving; 105 lumens per watt. Consumes only 10.5-Watts of electricity; equivalent to 60-Watt incandescent lamp or 23-Watt Compact Fluorescent Lamp.
- Fast, labor-saving installation.
- Suitable for use with all non-metallic wiring systems.
- Can be Surface or Ceiling mounted.
- Indoor, outdoor, damp or wet location applications.
- Can be used for applications where high-pressure wash down is required.
- Mounts directly to any EPCO 4" Junction Box.
- Warranty: Five (5) years.
- Meets the requirements of the 2023 National Electrical Code: Articles 410.10(A), 410.36(A), 410.50, 410.52, 410.56, 547.1(A)(B), 547.4, 547.22, and 547.23.

### Features

- Blends with existing light fixtures and complements sight line uniformity.
- Optimal illumination, significant energy savings and virtually no luminaire maintenance.
- Circular distribution pattern evenly distributes light at all lateral angles; requires fewer lighting luminaires. See Figure 1.
- ProSeries AG LED Utility Luminaire includes:
  - » LED Light Engine with superior optics to magnify LED lumen output with minimal glare.
  - » Frosted UV and impact resistant Polycarbonate Diffuser.
  - » High temperature, continuous red silicone gasket (ensures a water-resistant seal against material debris, water, or moisture ingress).
  - » Cast-aluminum Heat Sink finished with a black, electrically applied "E-Coat" paint material that will not rust or corrode in the harshest environment.
  - » Lightweight, compact, and timeless styling.



ProSeries AG LED Utility Luminaire  
(P/N: 15924)



ProSeries AG LED Utility Luminaire shown with SPIDERBOX™ Junction Box with Glue-in Hubs  
(Optional accessory; see Page 3 for more information)

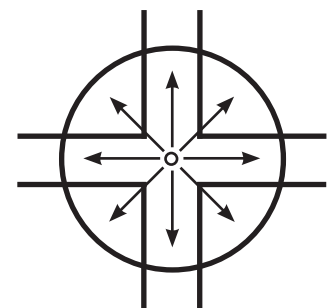

Figure 1: Circular light distribution pattern

## ProSeries AG LED Utility Luminaire Specifications

Lumen Output	1,100+/-10%
Wattage	10.5-Watts
Power Consumption	0.10 Amps
Operating Voltage	120 Volts only
Power Factor	0.9 Minimum
Total Harmonic Distortion	<20%
Correlated Color Temperature (CCT)	5000K (+ or - 300K)
Color Rendering Index (CRI)	>80
LED Circuits	50,000 Hours
Efficacy	105 lm/W
Applications	Dry, Damp, or Wet Environments
Operating Temperature	-4°F (-20°C) to 122°F (50°C)
Warranty	50,000 Hours / 5-years at L <sub>70</sub>
Dimming	Non-Dimmable
Certifications	<ul style="list-style-type: none"> <li>■ cULus</li> <li>■ IP65 Certified</li> <li>■ Meets the requirements of the 2023 National Electrical Code: Articles 410.10(A), 410.36(A), 410.50, 410.52, 410.56, 547.1(A)(B), 547.4, 547.22, and 547.23.</li> <li>■ FCC, Part 15. This device complies with part 15 of the FCC Rules. Operation is subject to the following two conditions: (1) This device may not cause harmful interference, and (2) this device must accept and interference received, including interference that may cause undesired operation."</li> </ul>

## PROSERIES AG LED UTILITY LUMINAIRE: PHOTOMETRICS

### CHARACTERISTICS

Lumens per Lamp	1100 (1 Amp)
Total Lamp Lumens	1100
Luminaire Lumens	1100
Total Luminaire Efficiency	100%
Luminaire Efficacy Rating (LER)	105
Total Luminaire Watts	10.47
Ballast Factor	1.00
CIE Type	Semi-Direct
Spacing Criterion (0-180)	1.58
Spacing Criterion (90-270)	1.58
Spacing Criterion (Diagonal)	1.70
Basic Luminous Shape	Circular w/Sides
Luminous Length (1-180)	0.21 Ft. Diameter
Luminous Length (90-270)	0.21 Ft. Diameter
Luminous Length (90-270)	0.13 Ft.

### LUMINANCE DATA (cd/sq/m)

Angle in Degrees	Angle in 0-Deg	Angle in 45-Deg	Angle in 90-Deg
45	48222	48222	48222
55	44992	44992	44992
65	40078	40078	40078
75	34118	34118	34118
85	28826	28826	28826

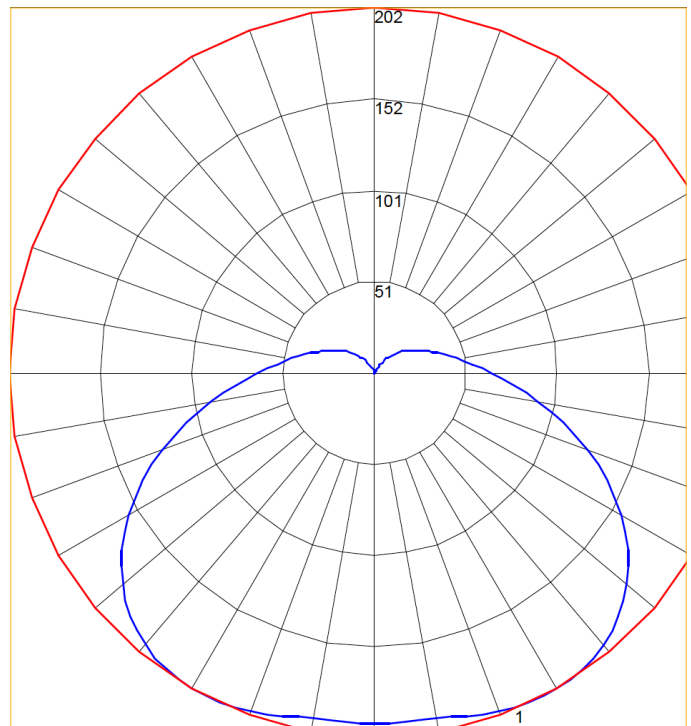

## INSTALLATION EXAMPLE

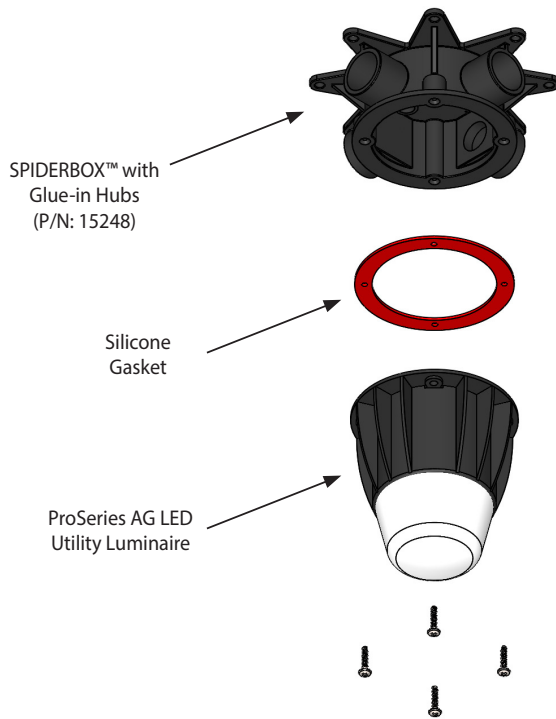

## DIMENSIONAL REFERENCES



## OPTIONAL ACCESSORY: SPIDERBOX™ JUNCTION BOXES WITH GLUE-IN HUBS

Engineered Products Company's SPIDERBOX Junction Box with Glue-in Hubs are specifically engineered to eliminate the .5" and .75" male terminal adapter and facilitate faster installation times when connecting schedule 40 PVC conduit to the junction box. The contractor saves time and lowers the overall installation cost.

This junction box is applicable for use with the ProSeries AG LED Utility Luminaire (P/N 15924).

### Features and Benefits

- 12-Cubic Inch capacity.
- Four (4) Glue-in Hubs — two (2) open and two (2) closed.
- Eliminates using a 1/2" (.5) or 3/4" (.75") male terminal adapter.
- Faster Installation saves time and money.
- Recommended for use with 1/2" or 3/4" Schedule 40 PVC conduit.
- Construction — UL 94 - 5VA Thermoplastic, the industry standard plastic material.
- Suitable for use in dry, damp, or wet locations.
- Rated for up to 122°F (50°C).

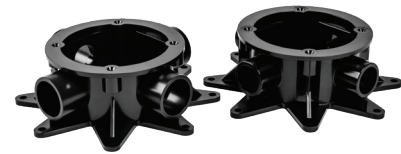

P/N: 15248

P/N: 15245

### SPIDERBOX™ Junction Box with Glue-in Hubs Specifications

Volume	12 Cubic Inches	Safety	cETLus Listed to UL 5A
Ports	4 — 2 Open, 2 Closed	Material	UL 94 — VA Thermoplastic
Port Size	1/2" and 3/4" Trade Size	Operating Temperature	-4°F (20°C) to 122°F (50°C)
Conduit	1/2" and 3/4" PVC	Warranty	1 year
Box Mounting	#8 Screws	Packaging	24 per Carton (Bulk)
Cover/Fixture Mounting	#8 x 3/4" Screws	Weight	0.4 lbs.

## PROSERIES AG LED UTILITY LUMINAIRE: PART NUMBERS

Catalog Number	UPC Number	Description	Order Unit	Unit Qty	Unit Pkg	Units/Case	TL Case Qty	Min Order Qty	MM Req	Ship Wt (Lbs)
<b>ProSeries AG LED Utility Luminaire</b>										
15924	15924	ProSeries AG LED Utility Luminaire: Includes One (1) Red Silicone Gasket and Four (4) Screws	EA	1	BX	12	12	1	No	2
<b>SPIDERBOX Junction Box with Glue-In Hubs</b>										
15245	15245	12 Cubic Inch, 1/2", Two (2) Open Hubs and Two (2) Knockout Hubs	EA	1	BX	24	24	24	Yes	6
15248	15248	12 Cubic Inch, 3/4", Two (2) Open Hubs and Two (2) Knockout Hubs	EA	1	BX	24	24	24	Yes	6
<b>SPIDERBOX Junction Boxes</b>										
15246	15246	12 Cubic Inch, 1/2" Knockouts	EA	1	BX	12	12	12	Yes	6
15247	15247	12 Cubic Inch, 3/4" Knockouts	EA	1	BX	12	12	12	No	6
<b>Standard Junction Boxes</b>										
15045	15045	12 Cubic Inch, 1/2" and 3/4" Knockout Combo	EA	1	BX	12	12	12	Yes	6
15046	15046	12 Cubic Inch, 1/2" Knockouts	EA	1	BX	12	12	12	Yes	6
15047	15047	12 Cubic Inch, 3/4" Knockouts	EA	1	BX	12	12	12	Yes	6
15049	15049	19 Cubic Inch, 3/4" Knockouts	EA	1	BX	12	12	12	Yes	6
<b>Junction Box Cover</b>										
15905	15905	Round Junction Box Cover and Neoprene Gasket	EA	1	BX	12	12	12	Yes	2

## PROSERIES LED: WARRANTY

Engineered Products Company (herein known as EPCO) warrants at its sole option, after a failure is confirmed as a true defect in materials or workmanship, EPCO will replace or refund, the ProSeries AG LED Utility Luminaire for a period of five (5) years from original purchase. This warranty statement applies to the original purchaser and is not transferable. If the product fails before the 5-year period expires, please return this product with your original invoice to: Engineered Products Company, Attention: Return Materials Department, 5401 Smetana Drive, Minnetonka, Minnesota 55343.

### This Limited Warranty does not apply to any of the following:

- Any ProSeries AG LED Utility Luminaire that was incorrectly installed by drilling holes, puncturing, piercing or any other means that will alter the product's integrity.
- Damage caused by the use of parts, components, and/or other equipment(s) that is not compatible, suitable, or unauthorized by EPCO for use with any ProSeries AG LED Utility Luminaire.
- Damage resulting from the use of any ProSeries AG LED Utility Luminaire in what EPCO, at its sole discretion, considers extreme applications.
- Product damage as determined by EPCO to be caused by a crash, impact, or obvious signs of abuse to any ProSeries AG LED Utility Luminaire.

### UNITS OF MEASURE KEY

**Order Unit:** The Unit to be ordered; **Order Qty:** Number of pieces in each Unit; **Unit Pkg:** Packaging types - BG (Bag), BX (Box), BRL (Barrel); **Units/Case:** Unit packages contained in the Case; **TL Case Qty:** The total number of items in each Master Case; **Min Order Qty:** The smallest Unit that can be ordered; **MM Req:** Must order multiples of the Unit in the stated quantities; **Ship Wt (Lbs):** Total weight of the units per Carton

E02-150-007 (08/23 AK)  
© 2023 Engineered Products Company. All Rights Reserved.  
ProSeries™ and SPIDERBOX™ are trademarks of Engineered Products Company.

